

# PolySTH

**Innovation Meets  
Affordability.**

Your Modern Solution  
in Plastic Fittings & Pipe

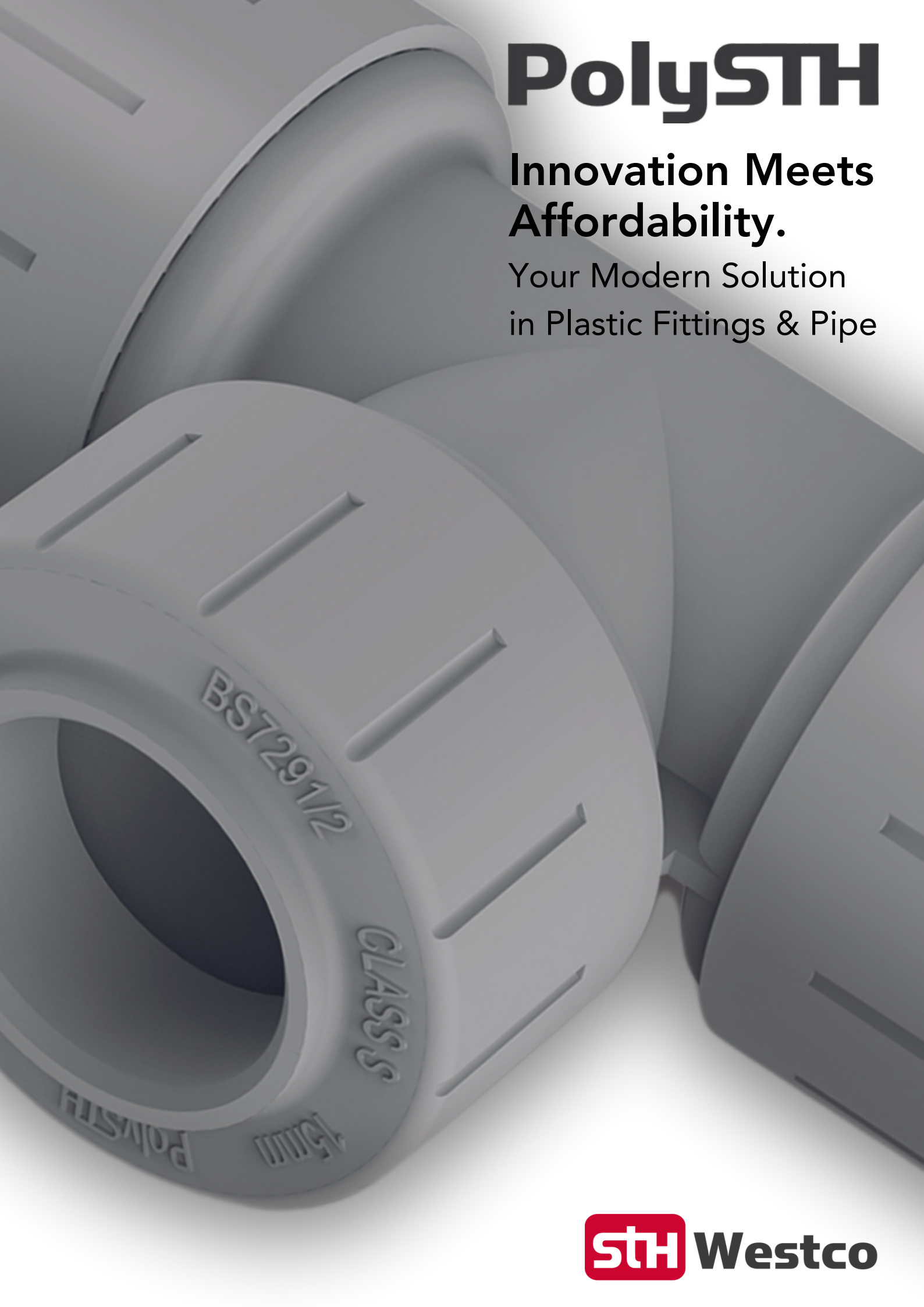



# PolySTH

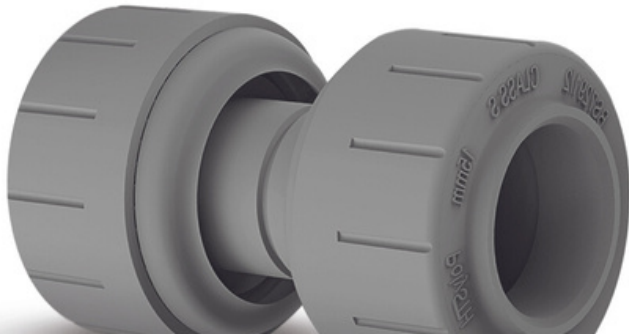

## PUSH-FIT FITTINGS

Polybutylene piping systems have been successfully used in European piping installations for almost 50 years. PolySTH is a well-established system that has proven its effectiveness with over four decades of its existence.

It is a quick and safe system to install and requires fewer joints than rigid piping systems. The joints do not require solvents, soldering or flames. PolySTH is more resistant to impacts and freeze bursts than rigid piping systems

### Advantages

- ✓ Time savings, faster assembly and disassembly than other systems.
- ✓ Clean and no tools needed. Secure joining system. Withstands temperature changes, hard water, shocks, etc.
- ✓ Due to its low weight, it is easy to handle and transport. It weighs less than ¼ the weight of copper.

### Characteristics

- ✓ The fitting can be disassembled and reused.
- ✓ Made of polybutylene.
- ✓ Fittings available in 15, 22 and 28mm.
- ✓ Corrosion and peeling proof.
- ✓ Ideal for use in hot and cold sanitary water supplies, central heating to radiators and underfloor central heating installations.



Quick and easy to install, reducing work time.

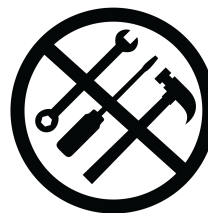

Simple and fast joining process eliminating the need for extra equipment, reducing health risks, and work time.



Plastic and lightweight material, reducing the risk of theft compared to alternative materials.

# PUSH-FIT FITTINGS

## Female 90° Elbow



Code	Size	Bag Qty	RRP
F64020	15mm	10	£24.99
F64021	22mm	10	£38.99
F64022	28mm	5	£45.99

## Straight Coupler



Code	Size	Bag Qty	RRP
F64049	15mm	10	£22.99
F64050	22mm	10	£48.99
F64051	28mm	5	£42.99

## Equal Tee



Code	Size	Bag Qty	RRP
F64036	15mm	10	£37.99
F64037	22mm	10	£49.99
F64038	28mm	5	£72.99

## Reduced Tee



Code	Size	Bag Qty	RRP
F64039	22 x 15 x 22mm	5	£25.99
F64042	22 x 15 x 15mm	5	£24.99
F64044	22 x 22 x 15mm	5	£25.99

## Socket Blank End



Code	Size	Bag Qty	RRP
F64070	15mm	10	£17.99
F64071	22mm	10	£25.49

## Straight Tap Connector



Code	Size	Bag Qty	RRP
F64067	15mm x 1/2"	10	£49.99
F64068	22mm x 3/4"	5	£34.99

## PUSH-FIT FITTINGS

# PolySTH

### Bent Tap Connector



Code	Size	Bag Qty	RRP
F64023	15mm x 1/2"	10	£64.99

### Male - Female 90° Elbow



Code	Size	Bag Qty	RRP
F64024	15mm	10	£29.99

### Male - Female Socket Reducer



Code	Size	Bag Qty	RRP
F64052	22 x 15mm	10	£43.99
F64053	28 x 22mm	5	£30.99

### Male - Male Spigot Reducer



Code	Size	Bag Qty	RRP
F64054	22 x 15mm	5	£4.99

### Female - Female Reducing Coupling



Code	Size	Bag Qty	RRP
F64056	22 x 15mm	5	£29.99

# PolySTH



## POLYBUTYLENE PIPE (PB)

PolySTH is a well-established system that has proven its effectiveness with over four decades of its existence and has a complete range of polybutylene pipes with diameters from 15 mm to 28 mm.

This system is fast and safe to install and requires fewer joints than rigid piping systems. The joints don't need dissolvents, welding or flames. PolySTH is more resistant to impacts and freeze punctures than rigid piping systems.

### Advantages

- ✓ Corrosion and freezing temperature resistance.
- ✓ Pressure variation resistance (water hammer).
- ✓ Low internal roughness, so the pressure drop is lower.
- ✓ Lightweight and manageable.

### Characteristics

- ✓ Fittings available from 15mm to 28mm.
- ✓ Anti-oxygen barrier to stop the ingress of any oxygen in the system.
- ✓ Ready to use straight out of the coil.
- ✓ Ideal for use in hot and cold sanitary water supplies, central heating to radiators and underfloor central heating installations.
- ✓ A flexible alternative to copper pipe which is still suitable for both hard and soft water areas.



Quick and easy to install, reducing work time.

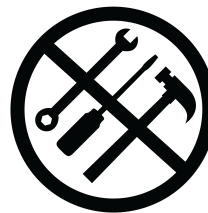

Simple and fast joining process eliminating the need for extra equipment, reducing health risks, and work time.



Plastic and lightweight material, reducing the risk of theft compared to alternative materials.

## POLYBUTYLENE PIPE (PB)

# PolySTH

### Barrier Pipe Coils



Code	Size	Roll	RRP
F64001	15mm	10M	£22.99
F64002	15mm	25M	£49.99
F64003	15mm	50M	£89.99
F64004	15mm	100M	£199.99
F64006	22mm	25M	£99.99
F64007	22mm	50M	£189.99
F64008	28mm	25M	£169.99

### Barrier Pipe 2M Lengths



Code	Size	Quantity	RRP
F64010	15mm	5	£14.99
F64012	22mm	5	£34.99

## PUSH-FIT ACCESSORIES

### Pipe Insert



Code	Size	Bag Qty	RRP
F64085	15mm	50	£15.99
F64086	22mm	50	£21.99
F64087	28mm	20	£22.99

### Spare Component Kit



Code	Size	Bag Qty	RRP
F64091	15mm	10	£13.99
F64092	22mm	10	£19.99
F64093	28mm	10	£24.99

**STH Westco**

Tel: 01942 603 351

Email: [contactcentre@westco.co.uk](mailto:contactcentre@westco.co.uk)

Web: [www.westco.co.uk](http://www.westco.co.uk)

# PUSH-FIT FITTINGS

## General Accessory Configuration

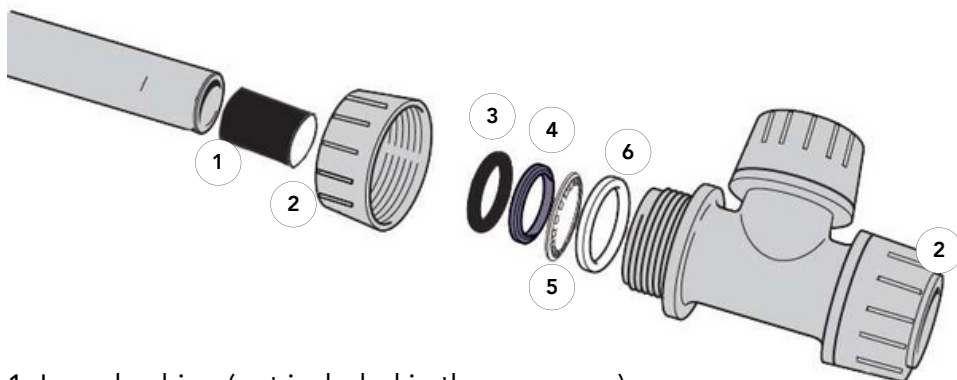

1. Inner bushing (not included in the accessory)
2. Polybutylene nut and body
3. EPDM O-ring
4. Polyamide plastic washer I
5. Stainless retaining ring
6. Polyamide Plastic Washer II

## Terms of Service

Temperature	20°C	30°C	40°C	50°C	60°C	70°C	80°C	90°C	114°C*
Pressure (bars)	12,0	11,5	11,0	10,5	9,0	8,0	7,0	6,0	3,0

\*Malfunction temperature.



# POLYBUTYLENE PIPE (PB)

## Materials

1. PB
2. Adhesive
3. Anti-oxygen barrier (BAO)
4. Adhesive
5. PB

STH POLY:  
5 LAYERS



## Dimensions

Pipe Diameter (mm)	15	22	28
Internal Diameter (mm)	11.6	18	22.8
Wall Thickness (mm)	1.7	2.0	2.6
Weigh (g/m)	70	130	220
Water Volume (l/m)	0.110	0.257	0.422

## Terms of Service

Temperature	20°C	30°C	40°C	50°C	60°C	70°C	80°C	90°C	114°C*
Pressure (bars)	12,0	11,5	11,0	10,5	9,0	8,0	7,0	6,0	3,0

\*System Malfunction temperature.

Application Class	Temperature of Design TD (°C)	Time to TD (Years)	Tmax (°C)	Time to Tmax (h)	Tmal (°C)	Time to Tmal (h)	Typical Application
1 <sup>a</sup>	60	49	80	1	95	100	Hot water supply (60°C)
2 <sup>a</sup>	70	49	80	1	95	100	Hot water supply (70°C)
4 <sup>b</sup>	20	2.5	70	2.5	100	100	Underfloor central heating and low temperature heating radiators.
	40	20					
	60	25					
5 <sup>b</sup>	20	14	90	1	100	100	High temperature heating radiators.
	60	25					
	80	10					

<sup>a</sup> Each country can choose between class 1 or class 2 according to its national regulations.

<sup>b</sup> When more than one design temperature appears for any class, the times must be added (for example, the 50 years temperature profile for class 5 is 14 years at 20°C, followed by 25 years at 60°C, 10 years at 80°C, 1 year at 90°C and 100 h at 100°C).

# PUSH-FIT FITTINGS

## Female 90° Elbow

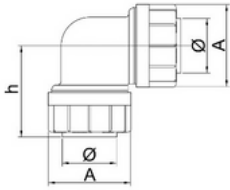

Code	Ø	A	h
F64020	15mm	32	35
F64021	22mm	40	41
F64022	28mm	47	51

## Straight Coupler

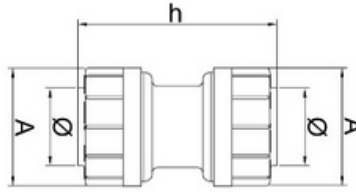

Code	Ø	A	h
F64049	15mm	30	53
F64050	22mm	40	62
F64051	28mm	46	71

## Equal Tee

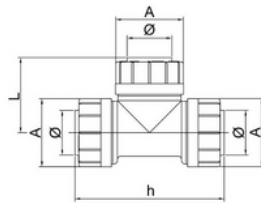

Code	Ø	A	h	L
F64036	15mm	32	77	35
F64037	22mm	40	82	41
F64038	28mm	47	103	50

## Reduced Tee

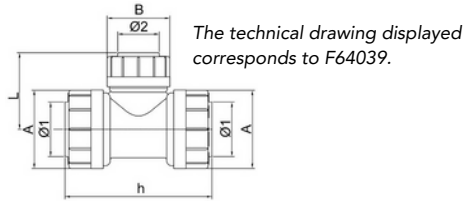

Code	Ø1	Ø2	A	B	h	L
F64039	22mm	15mm	40	32	74	39
F64042	22mm	15mm	40	32	72	40
F64044	22mm	15mm	40	32	80	41

## Socket Blank End

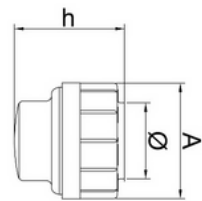

Code	Ø	A	h
F64070	15mm	32	30
F64071	22mm	40	35

## Straight Tap Connector

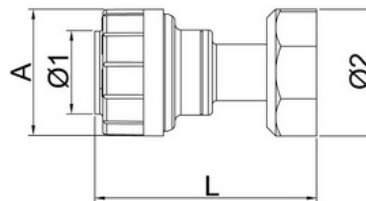

Code	Ø1	Ø2	A	L
F64067	15mm	1/2"	32	55
F64068	22mm	3/4"	40	65

# PUSH-FIT FITTINGS

## Bent Tap Connector

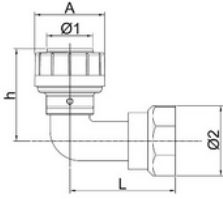

Code	Ø1	Ø2	A	h	L
F64023	15mm	1/2"	32	33	39

## Male - Female 90° Elbow

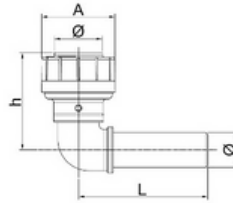

Code	Ø	A	L	h
F64024	15mm	32	56	30

## Male - Female Socket Reducer

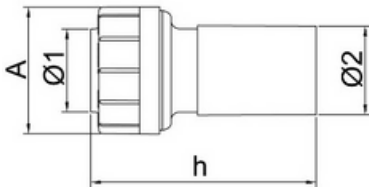

Code	Ø1	Ø2	A	h
F64052	15mm	22mm	32	60
F64053	22mm	28mm	40	55

## Male - Male Spigot Reducer

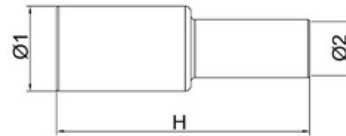

Code	Ø1	Ø2	h
F64054	22mm	15mm	65

## Female - Female Reducing Coupling

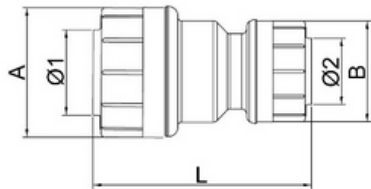

Code	Ø1	Ø2	A	B	L
F64056	22mm	15mm	40	32	65





# CONTACT US

Contact us today to discover how our UK national sales team can support your business needs. Whether you're seeking tailored solutions, expert advice, or top-quality products in the plumbing and heating industry, we're here to help. Reach out now to start building a successful partnership together.

## Accessible Communication Channels:

Reach out to our dynamic sales team through multiple channels including phone or email, for swift assistance.

## Expert Guidance:

Our seasoned sales professionals are equipped with extensive product knowledge and industry expertise to address all your inquiries effectively.

## Efficient Response Times:

We prioritise your queries and guarantee prompt responses, ensuring minimal waiting times and seamless communication.

## Dedicated Support:

Enjoy dedicated support throughout your journey, from initial contact to post-sales assistance, ensuring a smooth and rewarding experience.

## Customer-Centric Focus:

We prioritise your satisfaction and strive to exceed your expectations at every interaction, fostering long-term partnerships built on trust and reliability.

# NATIONWIDE COVERAGE



SCAN THE QR CODE  
TO CONTACT US

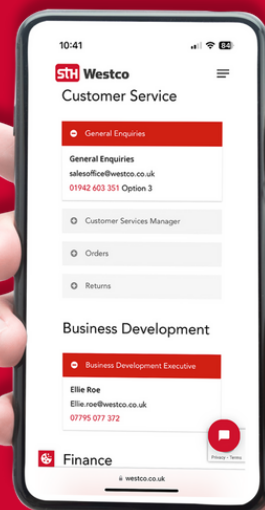





Tel: 01942 603 351

Email: [contactcentre@westco.co.uk](mailto:contactcentre@westco.co.uk)

Web: [www.westco.co.uk](http://www.westco.co.uk)